

NOTES:

1.MATERIAL:

HOUSING: THERMAL PLASTIC, GLASS FILLED, UL94V-0, COLOR: BLACK,
 COVER: THERMAL PLASTIC, COLOR : BLACK
 TERMINAL: COPPER ALLOY

2.TERMINAL :

CONTACT AREA: GOLD PLATED.
 SOLDER TAIL: TIN, THICKNESS=1.27 MICRONS MINIMUM
 UNDER PLATE: NICKEL, THICKNESS=1.27 MICRONS MINIMUM

3.PACKAGING : TRAY

4.PRODUCT SPECIFICATION REFER TO PS-67490-00*

5 MATING PART 67490,67491,67811,47080 SERIES

6.PRODUCT COMPLIANT TO RoHS DIRECTIVE 2002/95/EC AND ELV 2000/53/EC.

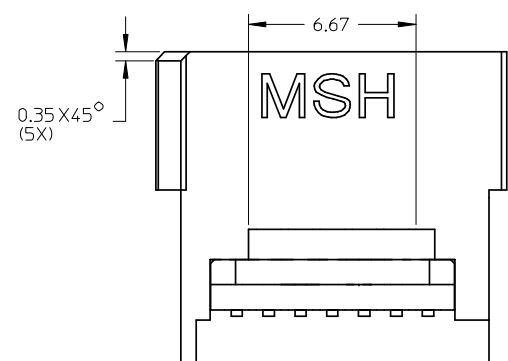
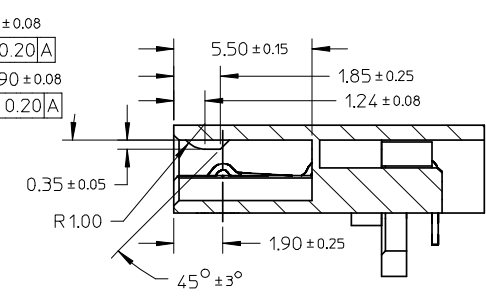
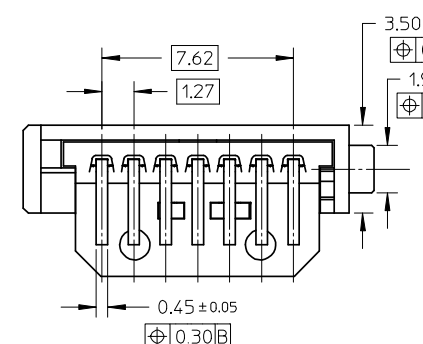
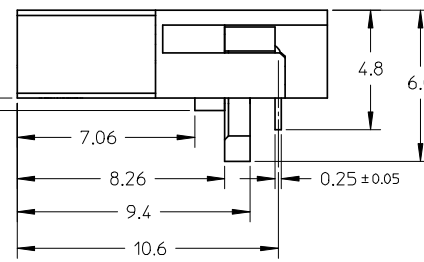
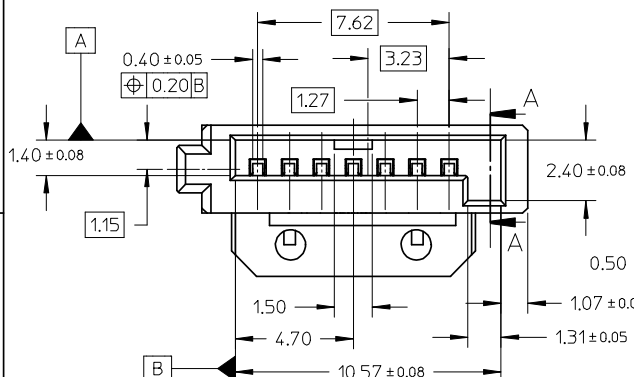

P/N	COMMENTS
67489-1001	GOLD FLASH
67489-1002	GOLD PLATED 0.76 MICRONS
67489-1005	GOLD PLATED 0.38 MICRONS
67489-1081	GOLD FLASH & HALOGEN FREE

REVISED EC NO: SH2008-0607 DRWN:HZA006 CHKD: APPR:HMWANG 2008/06/02 2008/06/02 2008/06/23 DESCRIPTION REV	QUALITY SYMBOLS	GENERAL TOLERANCES (UNLESS SPECIFIED)	DIMENSION STYLE	SCALE	DESIGN UNITS	THIRD ANGLE PROJECTION															
	▽=0 ≻=0	<table border="1"> <tr> <td></td> <td>mm</td> <td>INCH</td> </tr> <tr> <td>4 PLACES</td> <td>± ---</td> <td>± ---</td> </tr> <tr> <td>3 PLACES</td> <td>± ---</td> <td>± ---</td> </tr> <tr> <td>2 PLACES</td> <td>± 0.2</td> <td>± ---</td> </tr> <tr> <td>1 PLACE</td> <td>± 0.3</td> <td>± ---</td> </tr> </table> ANGULAR ± 1 °		mm	INCH	4 PLACES	± ---	± ---	3 PLACES	± ---	± ---	2 PLACES	± 0.2	± ---	1 PLACE	± 0.3	± ---	MM ONLY	1:1	METRIC	☉ ☐ THIRD ANGLE PROJECTION
		mm	INCH																		
	4 PLACES	± ---	± ---																		
3 PLACES	± ---	± ---																			
2 PLACES	± 0.2	± ---																			
1 PLACE	± 0.3	± ---																			
DRAFT WHERE APPLICABLE MUST REMAIN WITHIN DIMENSIONS	<table border="1"> <tr> <td>DRAWN BY</td> <td>DATE</td> <td>TITLE</td> </tr> <tr> <td>GRATE MA</td> <td>2004/03/25</td> <td rowspan="3">SERIAL ATA RECEPTACLE SIGNAL CABLE CONNECTOR WITHOUT METAL LATCH</td> </tr> <tr> <td>CHECKED BY</td> <td>DATE</td> </tr> <tr> <td>YAJUN</td> <td>2004/03/25</td> </tr> <tr> <td>APPROVED BY</td> <td>DATE</td> <td rowspan="2">MOLEX INCORPORATED</td> </tr> <tr> <td>SAM</td> <td>2004/03/25</td> </tr> </table>	DRAWN BY	DATE	TITLE	GRATE MA	2004/03/25	SERIAL ATA RECEPTACLE SIGNAL CABLE CONNECTOR WITHOUT METAL LATCH	CHECKED BY	DATE	YAJUN	2004/03/25	APPROVED BY	DATE	MOLEX INCORPORATED	SAM	2004/03/25	MATERIAL NO. SEE TABLE	DOCUMENT NO. SD-67489-003	SHEET NO. 1 OF 2		
DRAWN BY	DATE	TITLE																			
GRATE MA	2004/03/25	SERIAL ATA RECEPTACLE SIGNAL CABLE CONNECTOR WITHOUT METAL LATCH																			
CHECKED BY	DATE																				
YAJUN	2004/03/25																				
APPROVED BY	DATE	MOLEX INCORPORATED																			
SAM	2004/03/25																				
		SIZE	THIS DRAWING CONTAINS INFORMATION THAT IS PROPRIETARY TO MOLEX INCORPORATED AND SHOULD NOT BE USED WITHOUT WRITTEN PERMISSION																		

10 9 8 7 6 5 4 3 2 1

F

E

D

C

B

A

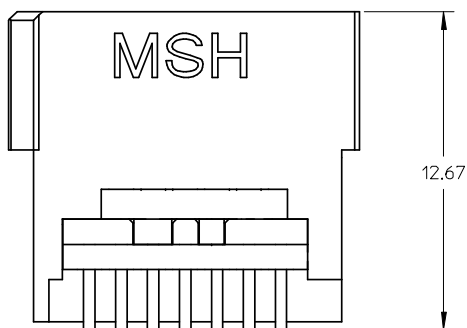
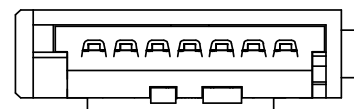
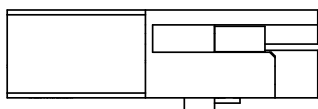
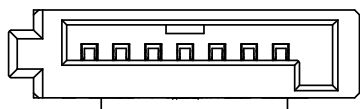
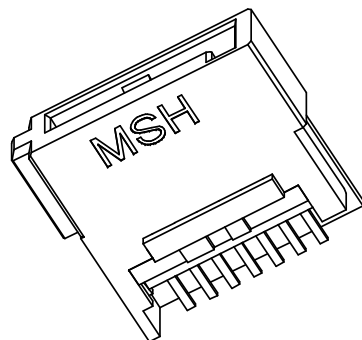
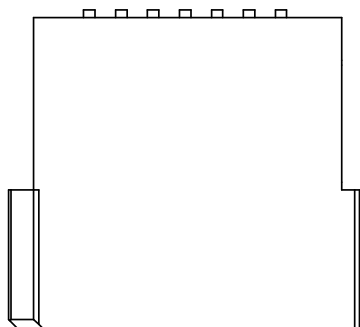

THESE ARE ONLY FOR 67489-800*, OTHERS INFORMATION ARE REFERED TO 67489-1001.

P/N	PLATING TYPE
67489-8001	GOLD FLASH
67489-8002	GOLD PLATED 0.76 MICRONS
67489-8005	GOLD PLATED 0.38 MICRONS

REVISED EC NO: SH2008-0607 DRW:HZHA006 CH'D: APPR:HWANG	2008/06/02 2008/06/02 2008/06/23	DESCRIPTION REV	QUALITY SYMBOLS	GENERAL TOLERANCES (UNLESS SPECIFIED) mm INCH 4 PLACES ± --- ± --- 3 PLACES ± --- ± --- 2 PLACES ± 0.2 ± --- 1 PLACE ± 0.3 ± --- ANGULAR ± 1 ° DRAFT WHERE APPLICABLE MUST REMAIN WITHIN DIMENSIONS	DIMENSION STYLE	SCALE	DESIGN UNITS	THIRD ANGLE PROJECTION
	MM ONLY		1:1		METRIC	☉		
	DRAWN BY: GRATE MA CHECKED BY: YAJUN APPROVED BY: SAM MATERIAL NO.		DATE: 2004/03/25 DATE: 2004/03/25 DATE: 2004/03/25		TITLE SERIAL ATA RECEPTACLE SIGNAL CABLE CONNECTOR WITHOUT METAL LATCH			
	SEE TABLE				MOLEX INCORPORATED DOCUMENT NO. SD-67489-003		SHEET NO. 2 OF 2	

9 8 7 6 5 4 3 2 1